



5" and 12" PLATE SHEARS

OWNER'S MANUAL



WARNING:

Read carefully and understand all ASSEMBLY AND OPERATION INSTRUCTIONS before operating. Failure to follow the safety rules and other basic safety precautions may result in serious personal injury.

Item #s 49698 & 49717



5" and 12" PLATE SHEARS OWNER'S MANUAL

Thank you very much for choosing a Klutch product. For future reference, please complete the owner's record below:

Serial Number/Lot Date Code: _____ Purchase Date: _____

Save the receipt, warranty and these instructions. It is important that you read the entire manual to become familiar with this product before you begin using it.

These 5" and 12" Plate Shears are designed for certain applications only. Northern Tool and Equipment cannot be responsible for issues arising from modification or use of these products in an application for which they were not designed. We strongly recommend that these products not be modified and/or used for any application other than that for which they were designed.

For technical questions please call 1-800-222-5381.

Table of Contents

Intended Use	1
Technical Specifications	1
Important Safety Information	2
Specific Operation Warnings	3
Assembly	3
Before Each Use	3
Operating Instructions	3
After Each Use	4
Maintenance	4
Parts Diagram	4
Parts List	5
Replacement Parts	5
Limited Warranty	5

Intended Use

The KLUTCH 5 inch and 12 inch plate shears are suitable for shearing carbon steel plate and bar and can also be used to shear non-ferrous metals or plastic plate and bar.

Technical Specifications

49698, 12 inch Plate Shear

Property	Specification
Throat Depth	12" (305mm)
Sheet Metal, max.	1/4" (6mm)
Carbon Steel, max.	5/32" (4mm)
Stainless Steel Plate, max.	1/8" (3mm)
Steel Rod, max.	1/2" (13mm)
Handle Length	31-1/2" (800mm)

49717, 5 inch Plate Shear

Property	Specification
Throat Depth	5" (127mm)
Sheet Metal, max.	1/5" (5mm)
Carbon Steel, max.	1/8" (3mm)
Stainless Steel Plate, max.	3/32" (2mm)
Steel Rod, max.	3/8" (10mm)
Handle Length	15-3/4" (396mm)

Important Safety Information **WARNING:**

- Read and understand all instructions. Failure to follow all instructions may result in serious injury.
- The warnings, cautions, and instructions in this manual cannot cover all possible conditions or situations that could occur. Exercise common sense and caution when using this tool. Always be aware of the environment and ensure that the tool is used in a safe and responsible manner.
- DO NOT allow persons to operate or assemble this product until they have read this manual and have developed a thorough understanding of how the product works.
- DO NOT modify the product in any way. Unauthorized modification may impair the function and/or safety and could affect the life of the product. There are specific applications for which the product was designed.
- Use the right tool for the job. DO NOT attempt to force a small equipment to do the work of larger industrial equipment. There are certain applications for which this equipment was designed. It will do the job better and more safely at the capacity for which it was intended. DO NOT use this equipment for a purpose for which it was not intended.
- Industrial or commercial applications must follow OSHA requirements.

 **WARNING:****WORK AREA SAFETY**

- Inspect the work area before each use. Keep work area clean, dry, free of clutter, and well lit. Cluttered, wet, or dark work areas can result in injury. Using the box in confined work areas may put you dangerously close to other cutting tools and rotating parts.
- Do not use the box where there is a risk of causing a fire or an explosion; e.g., in the presence of flammable liquids, gases, or dust. The tool can create sparks, which may ignite the dust or fumes.
- Do not allow the box to come into contact with an electrical source. Contact will cause a shock.
- Keep children and bystanders away from the work area while operating the box. Do not allow children to play with the box.
- Be aware of all power lines, electrical circuits, water pipes, and other mechanical hazards in your work area. Some of these hazards may be below the work surface hidden from your view and may cause personal harm or property damage if unintentionally contacted.

PERSONAL SAFETY

- Stay alert, watch what you are doing, and use common sense when operating the box. Do not use the box while you are tired or under the influence of drugs, alcohol, or medication. A moment of inattention while operating the box may result in serious personal injury.
- Dress properly. Do not wear loose clothing, dangling objects, or jewelry. Keep your hair, clothing and gloves away from moving parts. Loose clothes, jewelry, or long hair can be caught.
- Use ANSI-Z87.1 compliant safety goggles or safety glasses with side shields, or when needed, a face shield. Use a dust mask in dusty work conditions. Also use non-skid safety shoes, hardhat, gloves, dust collection systems, and hearing protection when appropriate. This applies to all persons in the work area.
- Do not overreach. Keep proper footing and balance at all times.
- Secure the work with clamps or a vise instead of your hand when practical. This safety precaution allows for proper tool operation using both hands.

 **CAUTION****SHEAR USE AND CARE**

- Do not force the tool. Tools do a better and safer job when used in the manner for which they are designed. Plan your work, and use the correct tool for the job.
- Check for damaged parts before each use. Carefully check that the tool will operate properly and perform its intended function. Replace damaged or worn parts immediately. Never operate the tool with a damaged part.
- Store the tool when it is not in use. Store it in a dry, secure place out of the reach of children. Inspect the tool for good working condition prior to storage and before re-use.
- Use only accessories that are recommended by the manufacturer for use with your tool. Accessories that may be suitable for one tool may create a risk of injury when used with another tool. Never use an accessory that has a lower operating speed or operating pressure than the tool itself.

Specific Operation Warnings **WARNING:**

- Blade Hazard. Keep hands clear from the blade when operating.
- Wear the proper safety gear including ANSI Z87.1 compliant safety glasses and gloves.
- Fasten shear to a sturdy, level surface that is capable of holding the load of the shear and workpiece before use.
- The shear blades are very sharp! Keep body parts away from the cutting area, or serious injury may result
- Note: If the material seems too thick or too hard, do not force the shear! Instead, use a metal-cutting band saw to cut the workpiece.

Assembly

When first unpacking the shear from its shipping container, check to be sure that all parts are fully equipped and not damaged. (See the parts list for reference.)

The anti-rust grease on processing surfaces and other parts can be removed with Kerosene or another suitable degreaser.

To assemble and mount your shear, follow the steps below:

1. Secure the handle to the plate shear assembly using the included hex bolts and flat washers, as shown in the parts diagram on the next page.
2. Place the shear on the workbench, and use the holes in the base as a guide for drilling and attaching the shear to the workbench.
3. We recommend using through bolts (hex bolts that go through the workbench and are secured from the other side with flat washers and hex nuts) if possible. If it is not possible to use through bolts, use lag screws with flat washers and fasten the lag screws directly into the workbench

Before Each Use

Check the shear for wear or damaged parts and that it is debris-free to perform its function. Periodically, check that the shear is still securely held in place. Re-secure it as needed.

Operating Instructions **WARNING:**

Read and understand this manual to understand the equipment structure and principle before operating the shear. Failure to understand and follow all instructions may result in serious injury.

Note: The shear should be mounted on a hard surface or specific stand (not supplied). Leave plenty of room around machine for ease of operating and to avoid injury.

1. Before shearing, adjust the hold-down disc (#12) to secure the workpiece.
2. When ready to shear, raise the handle (#10), the upper blade (#4) will rise.
3. Insert the workpiece and position it as desired.
4. Pull the handle down to shear the workpiece.

After Each Use

Clear away any debris from the previously use to prepare for the next use.

Maintenance

Maintain your tool. It is recommended that the general condition of any tool be examined before it is used. Keep your tool in good repair by adopting a program of conscientious repair and maintenance in accordance with the recommended procedures found in this manual. Keep all cutting tools sharp and clean. Properly maintained cutting tools with sharp cutting edges are less likely to bind and are easier to control. Keep handles dry, clean, and free from oil and grease.

- Lubricate the rotating parts of the shear every day.

Parts Diagram

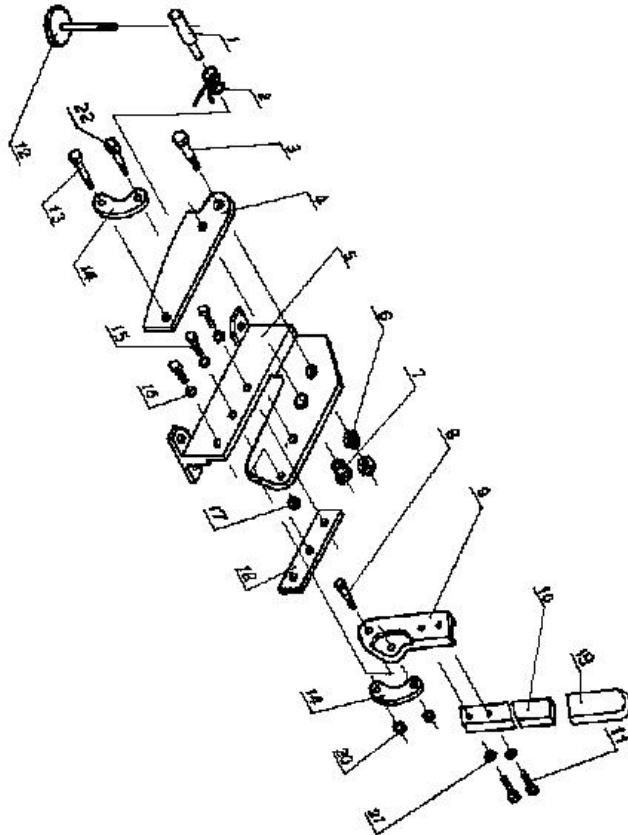

Parts List

Part No.	Description	Q'ty	Part No.	Description	Q'ty
1	Shaft	1	12	Disk	1
2	Spring	1	13	Screw	1
3	Bolt	1	14	Rocker	1
4	Upper blade	1	15	Screw	3
5	Body	1	16	Washer	3
6	Nut	2	17	Nut	1
7	Sleeve	1	18	Lower blade	1
8	Screw	1	19	Rocker	1
9	Lever	1	20	Nut	2
10	Handle	1	21	Washer	2
11	Screw	2	22	Screw	1

Replacement Parts

- For replacement parts and technical questions, please call Customer Service at 1-800-222-5381.
- Not all components are available for replacement. The illustrations provided are a convenient reference to the location and position of parts.
- The following are required when ordering parts: model number, serial number/lot date code, and description.
- The distributor reserves the rights to make design changes and/or improvements to product lines and manuals without notice.

Limited Warranty

Northern Tool and Equipment Company, Inc. ("We" or "Us") warrants to the original purchaser only ("You" or "Your") that the Ironton Air Tool product purchased will be free from material defects in both materials and workmanship, normal wear and tear excepted, for a period of one year from date of purchase. The foregoing warranty is valid only if the installation and use of the product is strictly in accordance with product instructions. There are no other warranties, express or implied, including the warranty of merchantability or fitness for a particular purpose. If the product does not comply with this limited warranty, Your sole and exclusive remedy is that We will, at our sole option and within a commercially reasonable time, either replace the product without charge to You or refund the purchase price (less shipping). This limited warranty is not transferable.

Limitations on the Warranty

This limited warranty does not cover: (a) normal wear and tear; (b) accessories both consumable and durable; (c) damage through abuse, neglect, misuse, or as a result of any accident or in any other manner; (d) damage from misapplication, overloading, or improper installation; (e) improper maintenance and repair; and (f) product alteration in any manner by anyone other than Us, with the sole exception of alterations made pursuant to product instructions and in a workmanlike manner.

Obligations of Purchaser

You must retain Your product purchase receipt to verify date of purchase and that You are the original purchaser. To make a warranty claim, contact Us at 1-800-222-5381, identify the product by make and model number, and follow the claim instructions that will be provided. The product and the purchase receipt must be provided to Us in order to process Your warranty claim. Any returned product that is replaced or refunded by Us becomes our property. You will be responsible for return shipping costs or costs related to Your return visit to a retail store.



5" and 12" PLATE SHEARS OWNER'S MANUAL

Remedy Limits

Product replacement or a refund of the purchase price is Your sole remedy under this limited warranty or any other warranty related to the product. We shall not be liable for: service or labor charges or damage to Your property incurred in removing or replacing the product; any damages, including, without limitation, damages to tangible personal property or personal injury, related to Your improper use, installation, or maintenance of the product; or any indirect, incidental or consequential damages of any kind for any reason.

Assumption of Risk

You acknowledge and agree that any use of the product for any purpose other than the specified use(s) stated in the product instructions is at Your own risk.

Governing Law

This limited warranty gives You specific legal rights, and You also may have other rights which vary from state to state. Some states do not allow limitations or exclusions on implied warranties or incidental or consequential damages, so the above limitations may not apply to You. This limited warranty is governed by the laws of the State of Minnesota, without regard to rules pertaining to conflicts of law. The state courts located in Dakota County, Minnesota shall have exclusive jurisdiction for any disputes relating to this warranty.



Distributed by
Northern Tool and Equipment Company, Inc.
Burnsville, Minnesota 55306
NorthernTool.com
Made in China